



Interroll deflection rollers can be used on the driven side of conveyor belts. The deflection roller with integrated bearings has a fixed shaft and the same dimensions as a drum motor.



**Technical data**

<b>Protection rate</b>	IP69k
<b>Max. belt tension</b>	See equivalent drum motor
<b>Max. belt speed</b>	See equivalent drum motor
<b>Shell length</b>	See equivalent drum motor
<b>Internal shaft sealing system</b>	NBR
<b>External shaft sealing system</b>	PTFE

**Design versions**

For idler pulleys you can choose the following design versions:

Component	Option	Material			
		Aluminum	Mild steel	Stainless steel	PTFE
Shell	Crowned		●	●	
	Cylindrical		●	●	
	Cylindrical + key for sprockets		●	●	
End housing		●		●	
Shaft				●	
External seal	PTFE				●

**Versions**

- Laggings for friction drive belts, page 60
- Laggings for modular plastic belts, page 64
- Laggings for positive drive solid homogeneous belts, page 68

## ACCESSORIES

Idler pulley with integrated bearings

### Dimensions

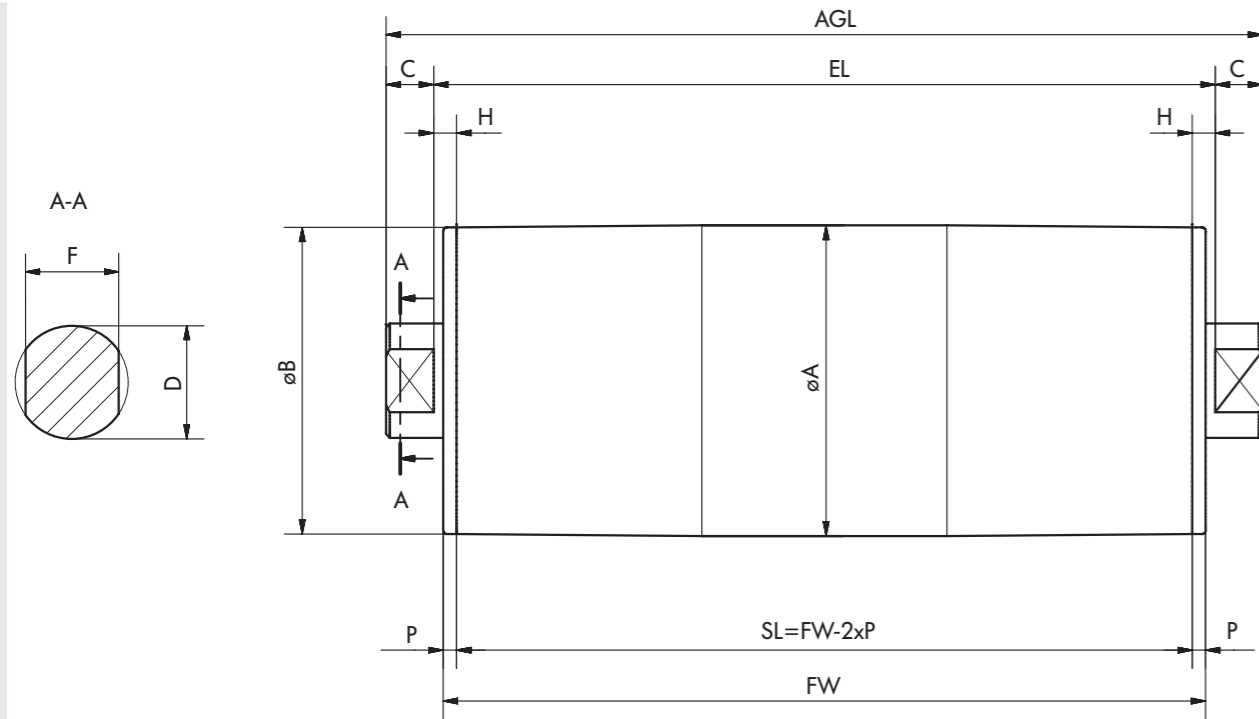

## ACCESSORIES

Idler pulley with integrated bearings

Type	A [mm]	B [mm]	C [mm]	D [mm]	F [mm]	H [mm]	P [mm]	SL [mm]	EL [mm]	AGL [mm]
DM 0080 crowned	81.5	80.5	12.5	30	25	6	3.5	FW - 7	FW + 5	FW + 30
DM 0080 crowned	81.5	80.5	12.5	25	20	6	3.5	FW - 7	FW + 5	FW + 30
DM 0080 crowned	81.5	80.5	12.5	17	13.5	6	3.5	FW - 7	FW + 5	FW + 30
DM 0080 cylindrical	81	81	12.5	30	25	6	3.5	FW - 7	FW + 5	FW + 30
DM 0080 cylindrical	81	81	12.5	25	20	6	3.5	FW - 7	FW + 5	FW + 30
DM 0080 cylindrical	81	81	12.5	17	13.5	6	3.5	FW - 7	FW + 5	FW + 30
DM 0113 crowned	113	112	25	30	25	10	3.5	FW - 7	FW + 13	FW + 63
DM 0113 crowned	113	112	25	25*	20	10	3.5	FW - 7	FW + 13	FW + 63
DM 0113 cylindrical	112	112	25	30	25	10	3.5	FW - 7	FW + 13	FW + 63
DM 0113 cylindrical	112	112	25	25*	20	10	3.5	FW - 7	FW + 13	FW + 63
DM 0113 cylindrical + key	113	113	25	30	25	10	3.5	FW - 7	FW + 13	FW + 63
DM 0113 cylindrical + key	113	113	25	25*	20	10	3.5	FW - 7	FW + 13	FW + 63
DM 0138 crowned	138	136	25	30	25	15	3.5	FW - 7	FW + 23	FW + 73
DM 0138 crowned	138	136	25	30	20**	15	3.5	FW - 7	FW + 23	FW + 73
DM 0138 cylindrical	136	136	25	30	25	15	3.5	FW - 7	FW + 23	FW + 73
DM 0138 cylindrical	136	136	25	30	20**	15	3.5	FW - 7	FW + 23	FW + 73
DM 0138 cylindrical + key	137	137	25	30	25	15	3.5	FW - 7	FW + 23	FW + 73
DM 0138 cylindrical + key	137	137	25	30	20**	15	3.5	FW - 7	FW + 23	FW + 73

\* Available from Q4/2018

\*\* Available from Q1/2019